

Fire Ribbon Direct Vent Slim 26" Vent Free and Direct Vent** with mandatory safety screen Front View

Model No.

26

Viewing Area

26.19" W x 14.5" H

Exterior Dimension

38.75" W x 27.25" H x 7.61" D

Framing Dimension

Mounts flush on wall

Gas Type*

Natural or LP/Propane

Gas Connection

1/2" pipe

On/Off

Programmable/thermostatic remote control standard with manual control panel on unit

Efficiency

Up to 80% for Direct Vent

Up to 95% for Vent Free

Direct Venting Options**

Through exterior wall or vertical through roof.

Vent Type**

Duravent DirectVent Pro 58DVA. Unit supplied with starter collar & wall pass through

Fan

n/a

Electric

n/a

Direct Vent BTU input**

11,000 - 19,000 BTU/h for natural gas

11,000 - 19,000 BTU/h for LP/Propane

16,000—26,000 BTU/h for natural gas

19,000—30,000 BTU/h for LP/Propane

Vent Free BTU input

Doors/glass

Fixed ceramic glass panel

Interior Color

Reflective Porcelain enamel firebox liner

Max Supply Pressure

10.0" w.c. for natural gas

13.0" w.c. for LP/Propane

Min Supply Pressure

5.5" w.c. for natural gas

11.0" w.c. for LP/Propane

Direct Vent Certifications

Omni-Test Laboratories Z21.88a-2007

CSA 2.33a-2007 CAN/CGA-2.17-M91

Vent Free Certifications

Omni-Test Laboratories ANSI Z21.11.2-2013

Options

Surround options are satin black or stainless steel

Media options are Ebony or Ice glass

*Must be specified at time of ordering.

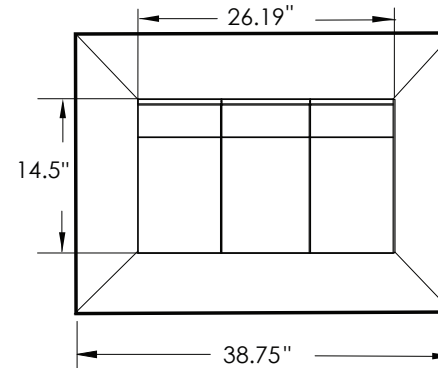

Top view

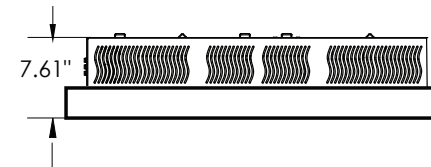

Side view

