

Fire made modern

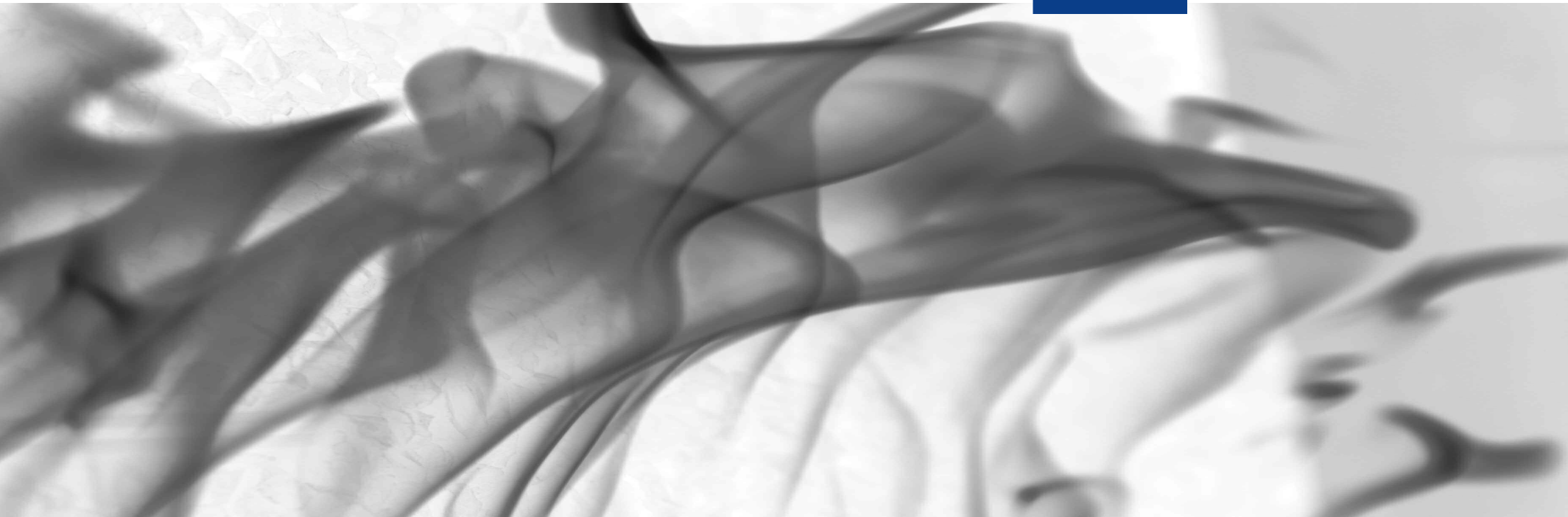

modern fires







SPARK

**modern fires** offers superior design

and outstanding performance—flawless fires for any well-designed environment. The SPARK fire is minimalist, modern, and pares fire to the essence of the flame itself. The old gas log is gone, replaced by sleek, simple lines and sophisticated design.

SPARK Modern Fires is the originator of the sleek, modern, flame-only fire. And SPARK's leading-edge innovation and design continue to make our products the professional's choice—an asset to the contemporary architect and designer.

SPARK's clean, updated aesthetic is matched only by its level of practical versatility. Each SPARK fire can be paired with a customizable surround in varying dimensions, details, and styles. Every fireplace is engineered to be extremely energy-efficient and design-forward.









**The Spark Story.** SPARK Modern Fires first launched its innovative Fire Ribbon gas fireplace at New York City's 2005 International Contemporary Furniture Fair. Immediately, SPARK set a new industry standard, establishing the modern gas fireplace as a compelling focal point.

With its superior engineering and outstanding design, SPARK Modern Fires has continued to revolutionize its category. Each SPARK fire is targeted to the exacting standards and creative demands of the design industry professional. And every one delivers the most efficient, effective heat possible.

*"Our approach has been to listen to the design professional—all our products are a result of listening to what the design community needs. We set out to create an innovative fireplace company that would be an asset to the contemporary designer, and the response has been astounding."*

**Tom Healy, SPARK Modern Fires Co-Founder**







## Fires That Inspire

SPARK fires are setting the mood in upscale luxury hotels, spas, restaurants and private residences throughout North America. A true modern fire, creating natural gathering spaces to relax—inside and out.



## Fire Ribbon Vent Free 3 ft

- **Available in one-sided view or two-sided view models**

This clever design proves that less is more. Even glass doors have been eliminated, leaving nothing but the appearance of a pure ribbon of fire.

Because no venting is required, this design offers extraordinary freedom in placement and installation. The Fire Ribbon Vent Free 3 ft can be placed on an interior or exterior wall. No chimney, flue, or hearth is needed. And its vent-free engineering more than satisfies stringent national standards of safety.

And now as a command performance, the design community requested it and SPARK delivered on the Vent Free Vu Thru. Double your vantage points with this stunning see through fireplace. Warmth, glow and energy are shared by adjoining spaces.

These fires are amazingly efficient—vent-free fires produce a very hot flame, resulting in over 95 percent efficiency. This is equipped with an Oxygen Depletion Sensor (ODS), a safety device to monitor room air quality.

Your design freedom continues with the choice of surrounds. You select the surround details, custom-fit to complement your environment. (See specs for model 53 on page 32, model 57 on page 33 and for Vu Thru model 54 on page 34)







## Fire Ribbon Vent Free 4 ft

- **Available in one-sided view or two-sided view models**

With the refined and narrow 48" dimension, modern fire now achieves perfect geometry. Optimal proportions enhance clean, uncluttered lines and flawlessly frame the pure ribbon of fire.

Because no venting is required, this design offers extraordinary freedom in placement and installation. The Fire Ribbon Vent Free 4 ft can be placed on an interior or exterior wall. No chimney, flue, or hearth is needed. And its vent-free engineering more than satisfies stringent national standards of safety.

The 4 ft Vu Thru model features an awe-inspiring 48" linear viewable width x two! A gorgeous and unique fireplace as a focal point of not one but two rooms. All of the looks and engineering times two. It makes a compelling wall divider between dining and family rooms.

Vent-free fires produce a very hot flame, resulting in over 95 percent efficiency. This is equipped with an Oxygen Depletion Sensor (ODS), a safety device to monitor room air quality. Your design freedom continues with the choice of surrounds. You select the surround details, custom-fit to complement your environment. (See specs for model 58 on page 35 and for Vu Thru model 59 on page 36)









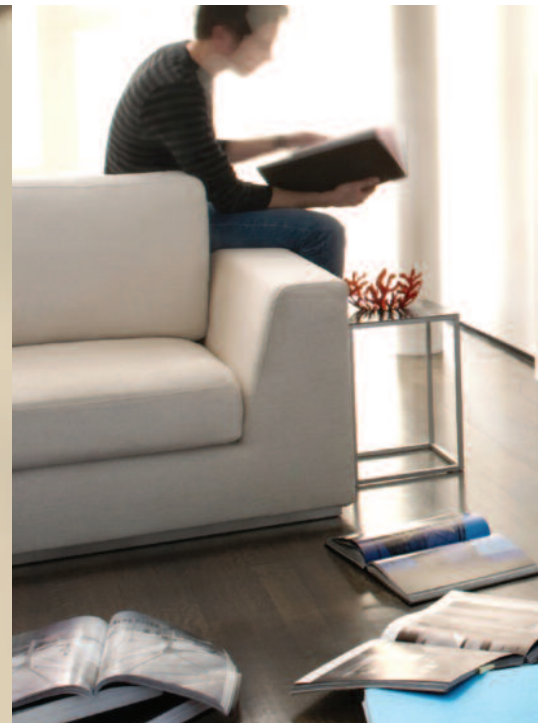



## Fire Ribbon Direct Vent 3 ft

- **Available in one-sided view or two-sided view models**

A truly modern fire—clean, uncluttered lines framing a pure ribbon of flame. A fixed glass window complements its sleek dimensions. The Fire Ribbon Direct Vent 3 ft provides a flawless focal point for any contemporary space. This fire goes anywhere it can vent to the outside, through a roof or an exterior wall.

The Fire Ribbon Direct Vent is also available as a see-through fireplace. The Vu Thru fireplace...one fire, two rooms. Built into bookcases or simply used as a room divider, the Vu Thru lets you share the warmth, glow and energy. Value engineering never felt so good!

These fires are extremely efficient and effective. Because air is drawn from outside, there are no drafts and no heat loss. In fact, this fireplace operates at an impressive efficiency rate of over 80 percent.

Finish your fire with the surround and fire objects of your choice. You design the details, custom-fit to your environment. (See specs for model 87/88 on page 37 and for the Vu Thru model 91/92 on page 38)







## Fire Ribbon Direct Vent 4 ft

Flawless fire meets perfect symmetry with this sleek, new dimension. Refined proportions provide the perfect frame for viewing a pure ribbon of fire.

With the refined and narrow 48" dimension, modern fire now achieves perfect geometry. Optimal proportions enhance clean, uncluttered lines and flawlessly frame the pure ribbon of fire. This fire is extremely efficient and effective. Because air is drawn from outside, there are no drafts and no heat loss. In fact, this fireplace operates at an impressive efficiency rate of near 80 percent.

Finish your fire with the surround of your choice. You design the details, custom-fit to your environment. (See specs for model 48 on page 39)





## Fire Ribbon Direct Vent 6 ft

Long and lean, this extended fire makes a dramatic statement—high-impact, while still sophisticated in design. A fixed glass window complements its sleek dimensions.

The Fire Ribbon Direct Vent 6 ft is the ultimate choice for a large, open space. Its linear effect creates a stunning focal point for any gathering place, whether in the home or a commercial environment. Place this fire anywhere it can vent to the outside, through a roof or an exterior wall. Install it quickly and easily, with no need for either a chimney or hearth.

Enhance the unique look of this fire with the surround and choice of fire objects.  
(See specs for model 19 on page 40)















## Slim 46" | 26"

- **Available in Direct Vent and now Vent Free**

A lean profile with substantial visual impact. This wall-mounted fire delivers maximum impact with minimum hassle. It hangs on the wall, saving space and costly installation or renovation. For the direct vent unit just vent through an outside wall or the roof, hang it—and enjoy. SPARK's signature Fire Ribbon look has never been easier.

At 8" deep, the lean design of this fire requires little space. A porcelain enamel interior reflects and enhances the beauty of the flame, creates depth. Choose between a stainless steel or black surround to enhance the look of this sleek fireplace. The fully programmable, thermostatic remote allows lighting and control from anywhere in the room. (See specs for model 46" | 26" on page 41)







**Linear Burner System** This fire is so completely customizable, gas fire becomes the ultimate designer's tool.

With SPARK's innovative Linear Burner System, create any fireplace length—from 24" to an incredible 120". Choose from multiple fire views—one-sided, two-sided on either an interior or exterior wall, or even a full 360-degree open fire with only an overhead hood.

This versatile modular system is made to retrofit into an existing firebox, transforming a wood-burning fireplace into a sleek, modern fire, or to create a custom fireplace.

Finish the linear burner system with the surround of your choice and a selection of fire objects. You design this fire, down to every last detail. (See specs for LBS on page 42)

## Linear Burner System Outdoor

SPARK's Linear Burner System Outdoor brings the sleek look and design versatility of our popular indoor fireplaces to your outdoor space. This innovative product will enhance any outdoor architectural feature or landscape design. Available in 2', 4', 6' and 8' lengths. This is flawless modern design, modified for outdoor living. You may never want to go back inside. (See specs for LOD on page 43)















## Fire Ribbon Outdoor

- **Available in one-sided view or two-sided view models**

Nothing gathers a crowd like fire. And when the night's air turns chilly there is no place you'd rather be. The Fire Ribbon Outdoor from SPARK extends the outdoor season in stunning form. This impressive fire radiates both beauty and heat, quite literally!

Because no venting is required, this design offers extraordinary freedom in placement and installation. No chimney, flue, or hearth is needed. And its vent-free engineering more than satisfies stringent national standards of safety. These fires are amazingly efficient—vent-free fires produce a very hot flame, resulting in over 95 percent efficiency. This is equipped with an Oxygen Depletion Sensor (ODS), a safety device to monitor room air quality.

Your design freedom continues with the choice of surrounds. You select the surround details, custom-fit to complement your environment. (See specs for model SS36 and SS48 on page 44 and 45 )

## The CUBE fire element

Spark's Cube fire element infuses outdoor living with dynamic contemporary design. When closed the stainless steel Cube projects as an art object worthy of illumination. While in use, the Cube casts it's own illumination and warmth emanating from a 60,000Ng or 54,000Lp btu burner. Purity of form. Engineered to inspire.  
(See specs for model 34 on page 46)











ebonyglass\*

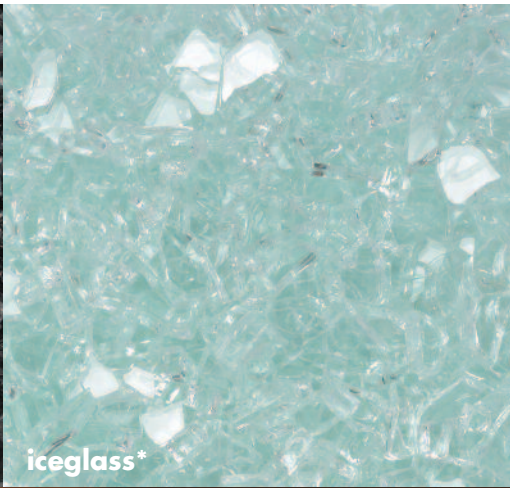

iceglass\*



shorestone \*



mixed beachstone







beachstone



pebblestone



moonston/pale



moonston/dark



lavastone\*

## Enhance your SPARK

When designing your fire ribbon, you have the option to accent the flame with a choice of fire objects. Place these fire objects surrounding the flame on a custom tray. Each will subtly enhance the clean design of your fire ribbon, while tailoring its look to your specific environment.

ebonyglass\*  
iceglass\*  
lavastone\*  
shorestone  
mixed beachstone

beachstone  
moonstone/pale  
moonstone/dark  
pebblestone

\*Also available for Linear Burner System

### Attention:

High heat retention properties ensure our fire stone and fire glass will withstand the extreme temperature of gas fire. Do not attempt to place other stones or glass in your fireplace, as they could break, crack or explode. It is now for use with vent-free Vu Thru model.

## Show us your SPARK

Here at SPARK, we love to see your creative ideas before, during, and after completion of your project. Please call us to review your designs and product selection. We're happy to help you get the best results with our SPARK products. A SPARK review will help expedite your specification process and help prevent costly mistakes.

...And don't forget to check for our design competitions and a chance to appear in our national advertising. Here are some of our previous winners.







## Fire Ribbon Vent Free 3 ft

<b>Model No.</b>	<b>53</b>
Viewing Area	36" W x 18" H
Exterior Dimension	41" W x 28.6" H x 18" D
Framing Dimension	42" W x 31.5" H x 18.5" D
Gas Type	Natural or LP/propane
Gas Connection	1/2" Pipe
On/Off	Remote control or wall switch
Efficiency	Over 95%
Venting Options	n/a
Vent Type	n/a
Fan	n/a
Electric	n/a
BTU input Natural gas	23,000 - 34,000 BTU/h
BTU input LP/propane	24,000 - 34,000 BTU/h
Doors/glass	No doors or fixed glass panels
Interior Color	Satin Black or Stainless Steel
Max Supply Pressure	10.5" w.c. for natural gas 13.0" w.c. for LP/propane
Min Supply Pressure	5.0" w.c. for natural gas 11.0" w.c. for LP/propane
Certifications	Omni Test Laboratories ANSI Z21.11.2-2011
Options	Stainless Steel firebox

### Restrictions:

Vent-free fireplaces are prohibited in certain geographies. Please check local codes. Canada, CA and NYC prohibit vent-free fireplaces. Vent-free fireplaces are also prohibited for use in bedrooms, bathrooms and above 4,500 ft elevation. Code prohibits any objects inside the fireplace during operation.

Front view

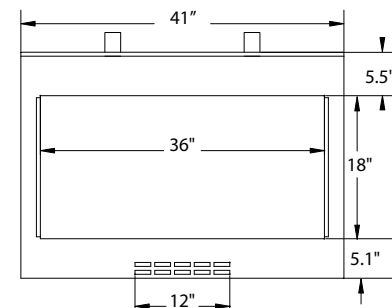

Top view

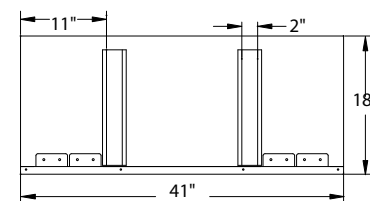

Right side view

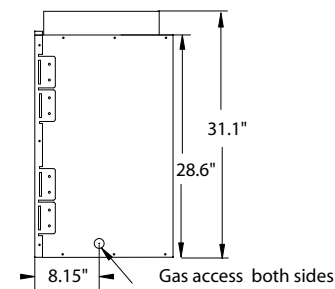

### Why pick a Vent Free 3 ft?

- Vent-free fireplaces can be installed on interior or exterior wall
- Over 95% efficient
- Lower cost to install since there is no chimney or flue
- Over 16 million units installed in U.S. since 1980
- 48 states approve installation of vent-free products
- Accepted by all major building and mechanical codes in the U.S. including the IBC (International Building Code) and the UMC (Uniform Mechanical Code). Please check with local codes before ordering.
- Oxygen Depletion Sensor (ODS) safety system



## Fire Ribbon Vent Free 3 ft

p. 866.938.3846

<b>Model No.</b>	<b>57E</b>
Viewing Area	36" W x 17.31" H
Exterior Dimension	48" W x 29.75" H x 18" D
Framing Dimension	49" W x 32.75" H x 18.5" D
Gas Type	Natural or LP/Propane
Gas Connection	1/2" pipe
On/Off	Remote control
Efficiency	Over 95%
Venting Options	n/a
Vent Type	n/a
Fan	n/a
Electric	110v with battery backup
BTU input Natural gas	24,000 - 34,000 BTU/h
BTU input LP/propane	23,000 - 34,000 BTU/h
Doors/glass	No doors or fixed glass panels
Interior Color	Satin Black or Stainless Steel
Max Supply Pressure	10.5" w.c. for natural gas 13.0" w.c. for LP/Propane
Min Supply Pressure	5.0" w.c. for natural gas 11.0" w.c. for LP/Propane
Certifications	Omni-Test Laboratories ANSI Z21.11.2-2011
Options	Stainless Steel firebox Fire Objects and Media Tray* *media tray required when using fire objects Safety screen

### Restrictions:

Vent-free fireplaces are prohibited in certain geographies. Please check local codes. Canada, CA and NYC prohibit vent-free fireplaces. Vent-free fireplaces are also prohibited for use in bedrooms, bathrooms and above 4,500 ft elevation.

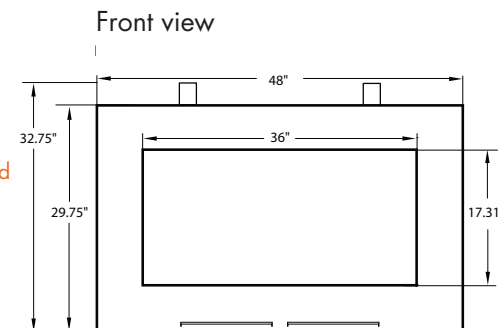

Top view

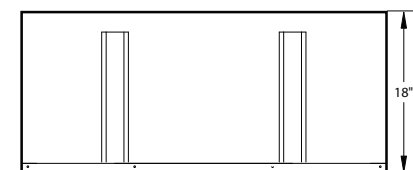

Right side view

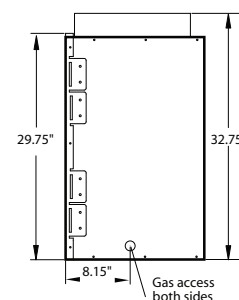

### Why pick a Vent Free 3 ft?

- Vent-free fireplaces can be installed on interior or exterior wall
- Over 95% efficient
- Lower cost to install since there is no chimney or flue
- Over 16 million units installed in U.S. since 1980
- 48 states approve installation of vent-free products
- Accepted by all major building and mechanical codes in the U.S. including the IBC (International Building Code) and the UMC (Uniform Mechanical Code). Please check with local codes before ordering.
- Oxygen Depletion Sensor (ODS) safety system

## Fire Ribbon Vent Free 3 ft Vu Thru

<b>Model No.</b>	<b>54E</b>
Viewing Area	36" W x 18" H
Exterior Dimension	41.16" W x 28.25" H x 18" D
Framing Dimension	42" W x 31.5" H x 17" D
Gas Type	Natural or LP/Propane
Gas Connection	1/2 " pipe
On/Off	Remote control
Efficiency	Up to 95%
Venting Options	n/a
Vent Type	n/a
Fan	n/a
Electric	110v with battery backup
BTU input Natural gas	24,000 - 34,000 BTU/h
BTU input LP/propane	24,000 - 34,000 BTU/h
Doors/glass	No doors or fixed glass panels
Interior Color	Satin Black or Stainless Steel
Max Supply Pressure	10.5" w.c. for natural gas 13.0" w.c. for LP/Propane
Min Supply Pressure	5.0" w.c. for natural gas 11.0" w.c. for LP/Propane
Certifications	Omni-Test Laboratories ANSI Z21.11.2a-2008
Options	Stainless Steel firebox Fire Objects and Media Tray* *media tray required when using fire objects Safety screen

### Restrictions:

Vent-free fireplaces are prohibited in certain geographies. Please check local codes. Canada, CA and NYC prohibit vent-free fireplaces. Vent-free fireplaces are also prohibited for use in bedrooms, bathrooms and above 4,500 ft elevation.

Front view

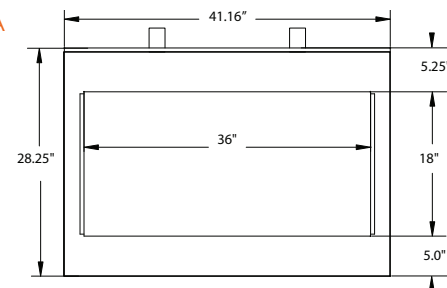

Top view

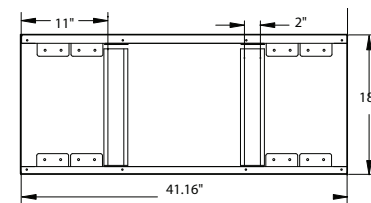

Right side view

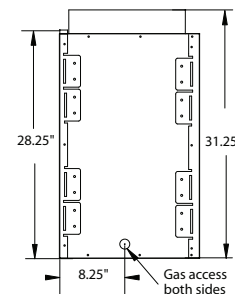

### Why pick a Vent Free Vu Thru?

- State-of-the-art electronic ignition
- Discrete air inlet
- Over 95% efficient
- Lower cost to install since there is no chimney or flue
- Oxygen Depletion Sensor (ODS) safety system
- The *Proflame System* remote control allows for 6 different adjustable flame height settings.



## Fire Ribbon Vent Free 4 ft

p. 866.938.3846

### Model No.

**58E**

Viewing Area  
Exterior Dimension  
Framing Dimension  
Gas Type  
Gas Connection  
On/Off  
Efficiency  
Venting Options  
Vent Type  
Fan  
Electric  
BTU input Natural gas  
BTU input LP/propane  
Doors/glass  
Interior Color  
Max Supply Pressure

48" W x 13.75" H  
60" W x 25.75" H x 18" D  
61" W x 29" H x 18.5" D  
Natural or LP/Propane  
1/2" pipe  
Remote control  
Over 95%  
n/a  
n/a  
n/a  
110v with battery backup  
25,500 - 39,000 BTU/h  
27,000 - 38,000 BTU/h  
No doors or fixed glass panels  
Satin Black or Stainless Steel  
10.5" w.c. for natural gas  
13.0" w.c. for LP/Propane  
5.0" w.c. for natural gas  
11.0" w.c. for LP/Propane  
Omni-Test Laboratories  
ANSI Z21.11.2-2012

Min Supply Pressure

Certifications

### Options

Stainless Steel firebox  
Fire Objects and Media Tray\*  
\*media tray required when using fire objects  
Safety screen

### Restrictions:

Vent-free fireplaces are prohibited in certain geographies. Please check local codes. Canada, CA and NYC prohibit vent-free fireplaces. Vent-free fireplaces are also prohibited for use in bedrooms, bathrooms and above 4,500 ft elevation.

Front view

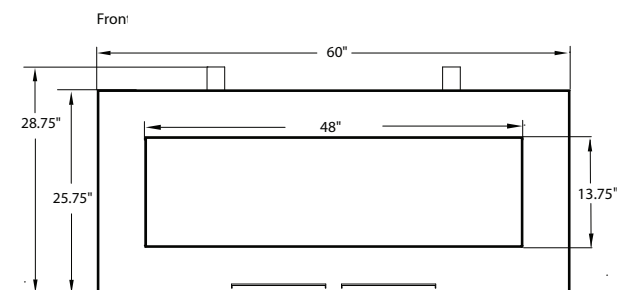

Top view

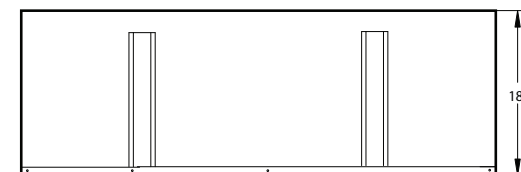

Right side view

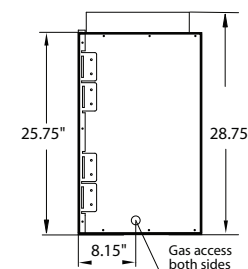

## Why pick a Vent Free 3 ft?

- Vent-free fireplaces can be installed on interior or exterior wall
  - Over 95% efficient
  - Lower cost to install since there is no chimney or flue
  - Over 16 million units installed in U.S. since 1980
  - 48 states approve installation of vent-free products
  - Accepted by all major building and mechanical codes in the U.S. including the IBC (International Building Code) and the UMC (Uniform Mechanical Code).
- Please check with local codes before ordering.
- Oxygen Depletion Sensor (ODS) safety system

## Fire Ribbon Vent Free 4 ft Vu Thru

### Model No.

**59E**

Viewing Area  
Exterior Dimension  
Framing Dimension  
Gas Type  
Gas Connection  
On/Off  
Efficiency  
Venting Options  
Vent Type  
Fan  
Electric  
BTU input Natural gas  
BTU input LP/propane  
Doors/glass  
Interior Color  
Max Supply Pressure

48" W x 13.75" H  
60" W x 25.75" H x 18" D  
61" W x 29" H x 17" D  
Natural or LP/propane  
1/2" Pipe  
Remote control  
Over 95%  
n/a  
n/a  
n/a  
110v with battery backup  
25,500 - 39,000 BTU/h  
27,000 - 38,000 BTU/h  
No doors or fixed glass panels  
Satin Black or Stainless Steel  
10.5" w.c. for natural gas  
13.0" w.c. for LP/propane  
5.0" w.c. for natural gas  
11.0" w.c. for LP/propane  
Omni Test Laboratories  
ANSI Z21.11.2-2011

Min Supply Pressure

Certifications

### Options

Stainless Steel interior firebox  
Fire Objects and Media Tray\*  
\*media tray required when using fire objects  
Safety screen

### Restrictions:

Vent-free fireplaces are prohibited in certain geographies. Please check local codes. Canada, CA and NYC prohibit vent-free fireplaces. Vent-free fireplaces are also prohibited for use in bedrooms, bathrooms and above 4,500 ft elevation.

Front view

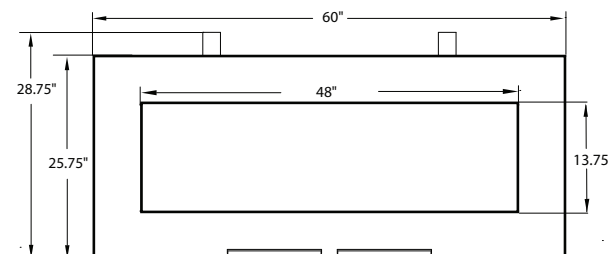

Top view

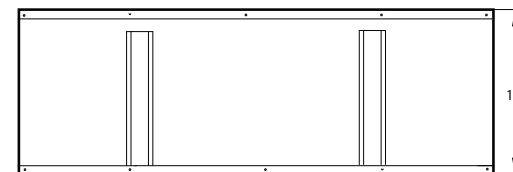

Right side view

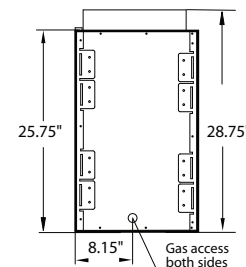

## Why pick a Vent Free Vu Thru?

- State-of-the-art electronic ignition
- Discrete air inlet
- Over 95% efficient
- Lower cost to install since there is no chimney or flue
- Oxygen Depletion Sensor (ODS) safety system
- The *Proflame System* remote control allows for 6 different adjustable flame height settings.



## Fire Ribbon Direct Vent 3 ft with mandatory safety screen

p. 866.938.3846

### Model No.

**87**

Does not require vertical venting

**88**

Requires 3' vertical vent before any horizontal venting

Viewing Area  
Exterior Dimension  
Framing Dimension  
Gas Type  
Gas Connection  
On/Off

36" W x 16" H  
45" W x 32" H x 22.5" D  
46" W x 36.25" H x 23" D  
Natural or LP/Propane\*  
1/2" pipe  
Programmable / thermostatic remote control standard  
Up to 80%  
Through exterior wall or vertical through roof.

36" W x 16" H  
45" W x 32" H x 22.5" D  
46" W x 36.25" H x 23" D  
Natural or LP/Propane\*  
1/2" pipe  
Programmable / thermostatic remote control standard  
Up to 80%  
Through exterior wall or vertical through roof.

Efficiency  
Venting Options

### Vent Type

Duravent DirectVent Pro 46DVA

Must source locally, not included.

Thermostat activated 160 c.f.m.

110 V

19,000 - 28,000 BTU/h

19,000 - 28,000 BTU/h

Fixed ceramic glass panel

Satin Black

10.5" w.c. for natural gas

13.0" w.c. for LP/Propane

4.5" w.c. for natural gas

11.0" w.c. for LP/Propane

Omni-Test Laboratories

ANSI Z21.88.2009

CSA 2.33-2009

Duravent DirectVent Pro 46DVA

Must source locally, not included.

Thermostat activated 160 c.f.m.

110 V

25,000 - 35,000 BTU/h

25,000 - 35,000 BTU/h

Fixed ceramic glass panel

Satin Black

10.5" w.c. for natural gas

13.0" w.c. for LP/Propane

4.5" w.c. for natural gas

11.0" w.c. for LP/Propane

Omni-Test Laboratories

ANSI Z21.88.2009

CSA 2.33-2009

Max Supply Pressure

Min Supply Pressure

Certifications

Options

Fire Objects and Media Tray\*

\*required when using fire objects

Fire Objects and Media Tray\*

\*required when using fire objects

### Why pick a Direct Vent 3 ft?

- Vent through the roof or exterior wall
- Up to 80% efficient
- Heating capacity enhanced with integrated fan
- Accepted by all major building and mechanical codes in the U.S. including the IBC (International Building Code) and the UMC (Uniform Mechanical Code). Please check with local codes before ordering.
- Approved in all 50 states and Canada
- No draft concerns

Front view

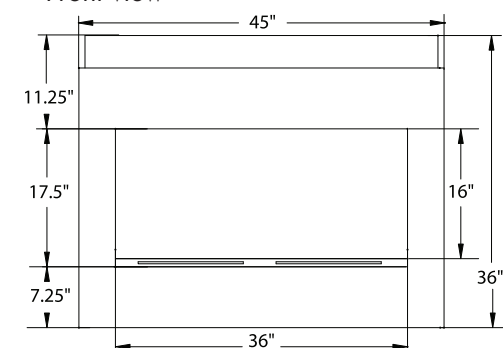

Top view

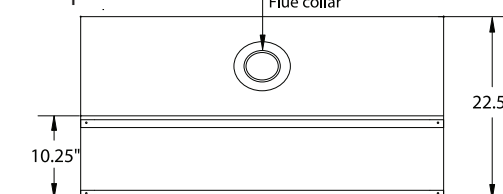

Right side view

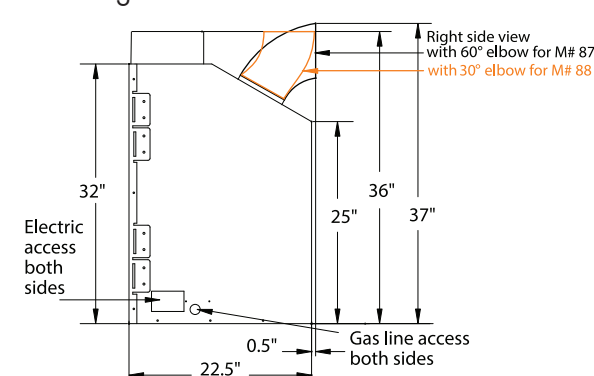

## Fire Ribbon Direct Vent Vu Thru with mandatory safety screen

Model No.	91	92
Viewing Area	36.33" W x 17" H	36.33" W x 17" H
Exterior Dimension	52.5" W x 32" H x 24" D	52.5" W x 32" H x 24" D
Framing Dimension	53.5" W x 40.5" H x 22.75" D	52.75" W x 40.5" H x 22.75" D Natural or LP/Propane
Gas Type	Natural or LP/Propane	LP/Propane
Gas Connection	1/2" pipe	1/2" pipe
On/Off	Programmable/thermostatic remote control standard	Programmable/thermostatic remote control standard
Efficiency	Up to 80%	Up to 80%
Venting Options	Through exterior wall or vertical through roof. <b>Must vent 2' vertically before horizontal venting.</b>	Through exterior wall or vertical through roof. <b>Must vent 2' vertically before horizontal venting.</b>
Vent Type	Duravent DirectVent Pro 46DVA Must source locally, not included.	Duravent DirectVent Pro 46DVA Must source locally, not included.
Fan	Thermostat activated 160 c.f.m.	Thermostat activated 160 c.f.m.
Electric	110 V.	110 V.
BTU input Natural gas	27,000 - 39,000 BTU/h	27,000 - 39,000 BTU/h
BTU input LP/propane	27,000 - 38,000 BTU/h	27,000 - 38,000 BTU/h
Doors/glass	2 Fixed ceramic glass panels	3 Fixed ceramic glass panels
Interior Color	Satin Black	Satin Black
Max Supply Pressure	10.5" w.c. for natural gas 13.0" w.c. for LP/Propane	10.5" w.c. for natural gas 13.0" w.c. for LP/Propane
Min Supply Pressure	5.0" w.c. for natural gas 11.0" w.c. for LP/Propane	5.0" w.c. for natural gas 11.0" w.c. for LP/Propane
Certifications	Omni-Test Laboratories ANSI Z21.88-2014, CSA 2.33-2014, CGA 2.17M91 (R2009), CSA P.4.1-09 (2014)	Omni-Test Laboratories ANSI Z21.88-2014, CSA 2.33-2014, CGA 2.17- M91 (R2009), CSA P. 4.1-09 (R2014)
Options	Fire Objects and Media Tray* *required when using fire objects	Fire Objects and Media Tray* *required when using fire objects

### Why pick a Direct Vent Vu Thru?

- Vent through the roof or exterior wall
- Up to 80% efficient
- Heating capacity enhanced with integrated fan
- Approved for bedrooms, bathrooms and all common rooms
- Accepted by all major building and mechanical codes in the U.S. including the IBC (International Building Code) and the UMC (Uniform Mechanical Code). Please check with local codes before ordering.
- Approved in all 50 states and Canada
- Safety of fixed ceramic glass
- No draft concerns

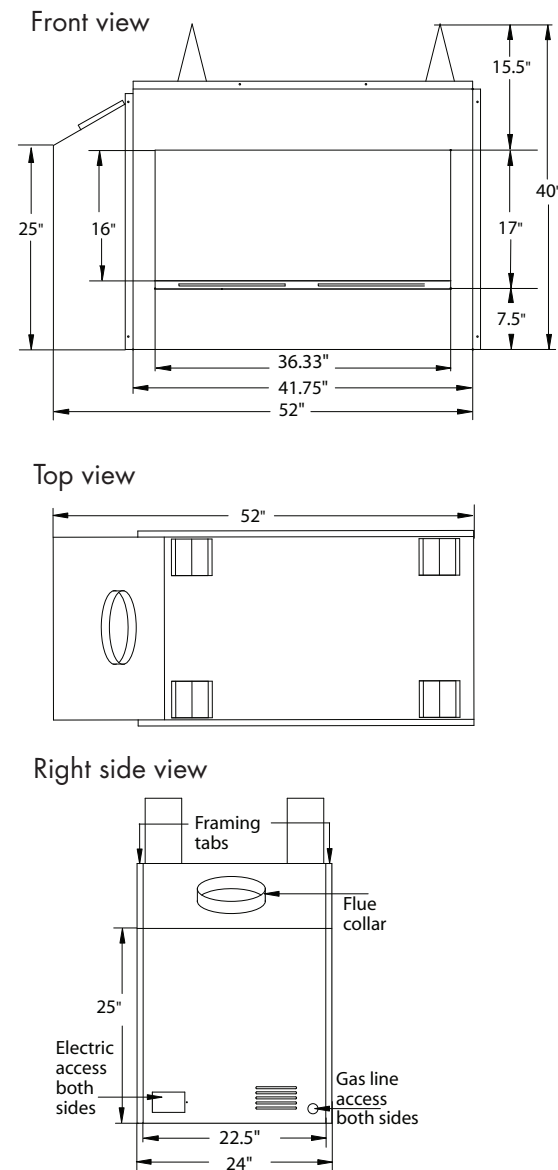



## Fire Ribbon Direct Vent 4 ft with mandatory safety screen

p. 866.938.3846

<b>Model No.</b>	<b>48</b>
Viewing Area	48.75" W x 13.75" H
Exterior Dimension	57.25" W x 28" H x 22.25" D
Framing Dimension	60" W x 34.5" H x 23.75" D
Gas Type	Natural or LP/Propane
Gas Connection	1/2" pipe
On/Off	Programmable / thermostatic remote control standard
Efficiency	Up to 80%
Venting Options	Through exterior wall or vertical through roof, <b>Must vent 1' vertically before horizontal venting.</b> Duravent DirectVent Pro 58DVA Must source locally, not included.
Vent Type	Thermostat activated 160 c.f.m.
Fan	110 V
Electric	27,000 - 39,000 BTU/h
BTU input Natural gas	27,000 - 38,000 BTU/h
BTU input LP/propane	Fixed ceramic glass panel
Doors/glass	Satin Black
Interior Color	10.5" w.c. for natural gas
Max Supply Pressure	13.0" w.c. for LP/Propane
Min Supply Pressure	4.5" w.c. for natural gas
Certifications	11.0" w.c. for LP/Propane
Options	Omni-Test Laboratories ANSI Z21.88 -2014, CSA 2.33 -2014, CGA 2.17 M91 (R2009), CSA P.4.1-09
	Fire Objects and Media Tray*
	*required when using fire objects

### Why pick a Direct Vent 4 ft?

- Vent through the roof or exterior wall
- Up to 80% efficient
- Heating capacity enhanced with integrated fan
- Accepted by all major building and mechanical codes in the U.S. including the IBC (International Building Code) and the UMC (Uniform Mechanical Code). Please check with local codes before ordering.
- Approved in all 50 states and Canada
- No draft concerns

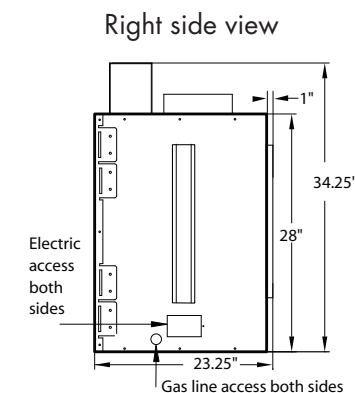
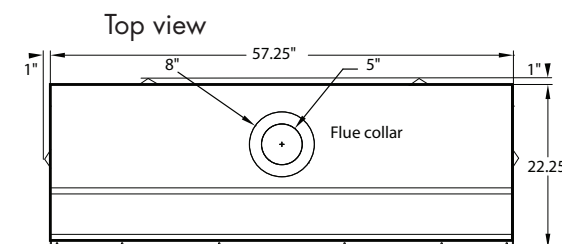
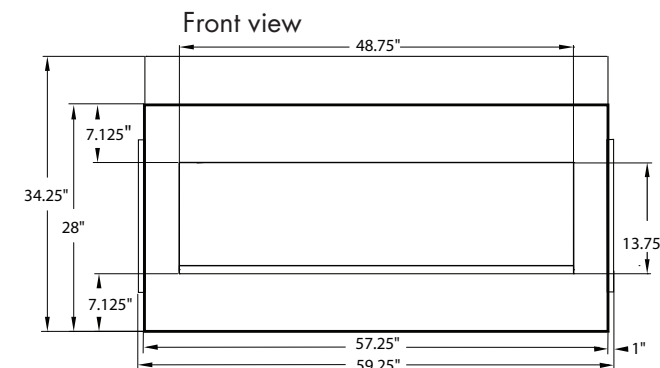

## Fire Ribbon Direct Vent 6 ft with mandatory safety screen

<b>Model No.</b>	<b>19</b>
Viewing Area	72.25" W x 15" H
Exterior Dimension	82.25" W x 32.19" H x 23.75" D
Framing Dimension	82.25" W x 38" H x 24.75" D
Gas Type	Natural or LP/Propane
Gas Connection	1/2" pipe
On/Off	Programmable / thermostatic remote control standard
Efficiency	Up to 80%
Venting Options	Through exterior wall or vertical through roof, <b>Must vent 3' vertically before horizontal venting.</b>
Vent Type	DuraVent DirectVent Pro 58DVA Must source locally, not included. Thermostat activated 160 c.f.m.
Fan	110 V.
Electric	40,000 - 64,500 BTU/h
BTU input Natural gas	37,000 - 64,500 BTU/h
BTU input LP/propane	Fixed ceramic glass panel
Doors/glass	Satin Black
Interior Color	10.5" w.c. for natural gas
Max Supply Pressure	13.0" w.c. for LP/Propane
Min Supply Pressure	4.5" w.c. for natural gas
Certifications	11.0" w.c. for LP/Propane Omni-Test Laboratories ANSI Z21.88-2009 CSA 2.33-2009
Options	Fire Objects and Media Tray* Power Venting *required when using fire objects

### Why pick a Direct Vent 6 ft?

- Vent through the roof or exterior wall
- Up to 80% efficient
- Heating capacity enhanced with two integrated fans
- Approved for bedrooms, bathrooms and all common rooms
- The Fire Ribbon 6' is ideally suited for spaces of at least 1,000 square feet
- Accepted by all major building and mechanical codes in the U.S. including the IBC (International Building Code) and the UMC (Uniform Mechanical Code). Please check with local codes before ordering.
- Approved in all 50 states and Canada
- No draft concerns

Front view

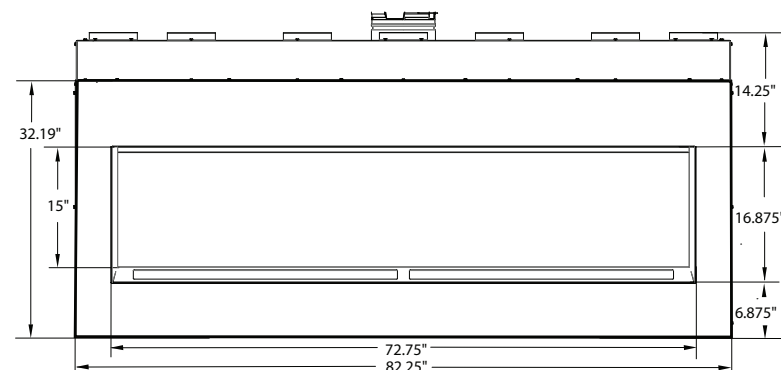

Top view

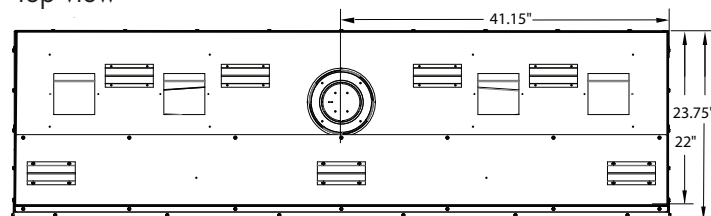

Right side view

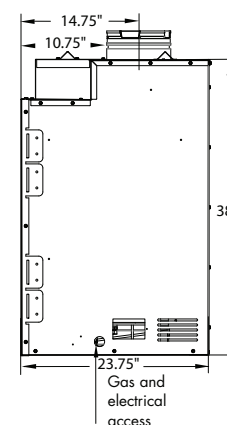



## Slim 46" | 26"

Vent Free and **Direct Vent\*\*** with mandatory safety screen

p. 866.938.3846

### Model No.

**46** 46VF

**26** 26VF

### Viewing Area

46" W x 12" H

26.19" W x 14.5" H

### Exterior Dimension

58.40" W x 25.25" H x 8" D

38.75" W x 27.25" H x 7.61" D

### Framing Dimension

Mounts flush on wall

Mounts flush on wall

### Gas Type

Natural or LP/Propane

Natural or LP/Propane

### Gas Connection

1/2" pipe

1/2" pipe

### On/Off

Programmable/thermostatic remote control standard with manual control panel on unit  
Up to 80% for Direct Vent  
Up to 95% for Vent Free

Programmable/thermostatic remote control standard with manual control panel on unit  
Up to 80% for Direct Vent  
Up to 95% for Vent Free

### Efficiency

### Direct Venting Options\*\*

#### Vent Type\*\*

Through exterior wall or vertical through roof.  
Duravent DirectVent Pro 58DVA. Unit supplied with starter collar & wall pass through

Through exterior wall or vertical through roof.  
Duravent DirectVent Pro 58DVA. Unit supplied with starter collar & wall pass through

### Fan

n/a

### Electric

n/a

### Direct Vent BTU input\*\*

19,000 - 29,000 BTU/h for natural gas

11,000 - 19,000 BTU/h for natural gas

19,000 - 29,000 BTU/h for LP/Propane

11,000 - 19,000 BTU/h for LP/Propane

### Vent Free BTU input

23,000—37,000 BTU/h for natural gas

16,000—26,000 BTU/h for natural gas

25,000—37,000 BTU/h for LP/Propane

19,000—30,000 BTU/h for LP/Propane

### Doors/glass\*\*

Fixed ceramic glass panel

Fixed ceramic glass panel

### Interior Color

Reflective Porcelain enamel firebox liner

Reflective Porcelain enamel firebox liner

### Max Supply Pressure

10.0" w.c. for natural gas

10.0" w.c. for natural gas

13.0" w.c. for LP/Propane

13.0" w.c. for LP/Propane

### Min Supply Pressure

5.5" w.c. for natural gas

5.5" w.c. for natural gas

11.0" w.c. for LP/Propane

11.0" w.c. for LP/Propane

### Direct Vent Certifications

Omni-Test Laboratories ANSI Z21.88a-2007

Omni-Test Laboratories Z21.88a-2007

CSA 2.33a-2007 CAN/CGA-2.17-M9

CSA 2.33a-2007 CAN/CGA-2.17-M91

### Vent Free Certifications

Omni-Test Laboratories ANSI Z21.11.2-2013

Omni-Test Laboratories ANSI Z21.11.2-2013

### Options

Surround options are satin black or stainless steel  
Media options are Ebony or Ice glass

Surround options are satin black or stainless steel  
Media options are Ebony or Ice glass

### \*\*Direct Vent units only

## Why pick a Slim 46" or a 26"?

- Only 8" deep off the wall
- Ease of installation. Simply mounts on the wall
- Versatile venting options—for Direct Vent through roof or exterior wall or no venting for Vent Free
- Light and control the unit directly from the fully programmable, thermostatic remote control or use the convenient manual control panel on side of unit (standard)
- Reflective porcelain enamel firebox liner reflects flames, enhancing depth and beauty of the flame

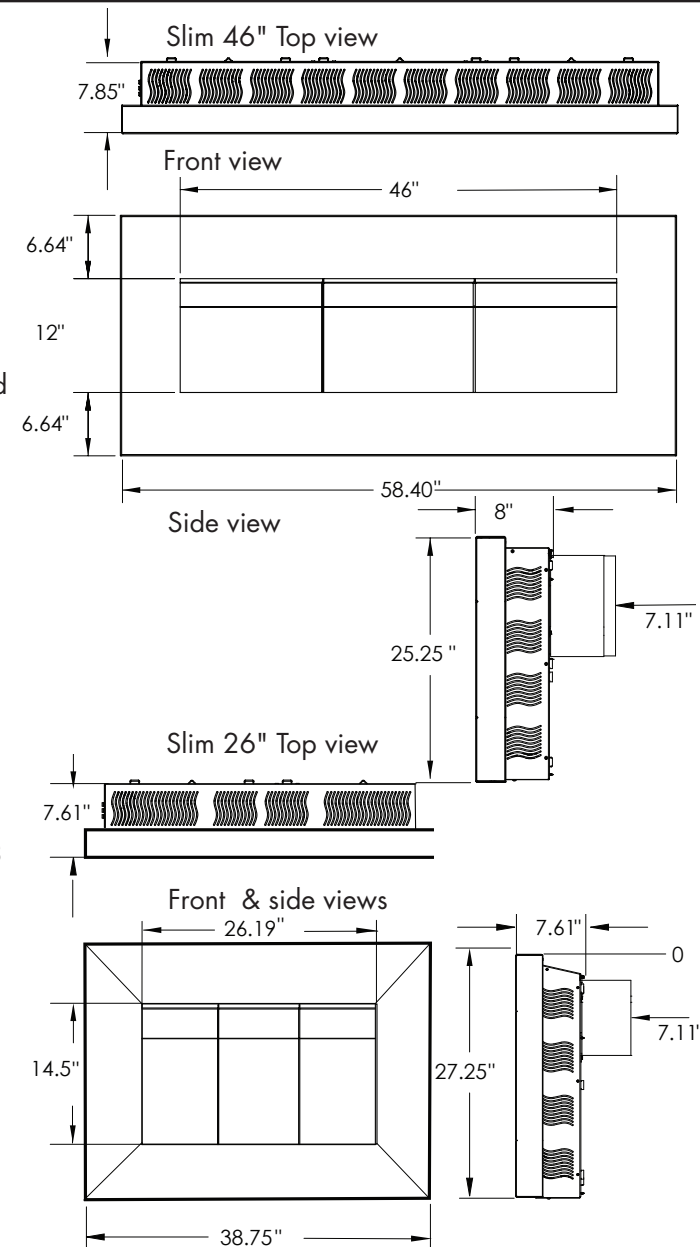

# Linear Burner System Indoor

Model No.	LBS 24   36   48   60   72   84   96
ExteriorDimension	Standing pilot 2' - 8' W x 5" H x 10" D Electronic ignition 2' - 8' W x 6" H x 10" D
Gas type*	Natural or propane
On/off	Remote control
Venting options	Masonry or class A flue vertical through the roof
Electrical	110 V. Electronic Ignition N/A for standing pilot
Accessory equipment	Recommended mechanized flue fan and mechanical damper Enervex.com
Burner appearance	Linear burner in lengths from 2' to 8' in 1' increments. Burner tube is submerged into bed of broken tempered glass.
Open air fire	Any glass doors must be open while in operation.
Media options	Tempered glass around the burner and approved colored glass or Lava stone as a topcoat
Fireplace configuration	Retrofit into an approved wood-burning fireplace. Appliance may be installed as a 1, 2, 3 or 4 sided fireplace with appropriate fireplace chimney.
Cooling Air Supply To Base Of Unit	12 sq. inches of fresh air per linear foot of burner with 1/2" air gap around entire assembly
Certifications	Omni-Test Laboratories ANSI Z21.60B-2004
*Must be specified at time of ordering.	CSA 2.26B-2004

**SPARK Modern Fires wants to help you achieve your fireplace vision. We will review your planned installation of the LBS. Please provide plan view and section drawings electronically, along with a rendering of the finishing details, and we will help you plan it properly.**

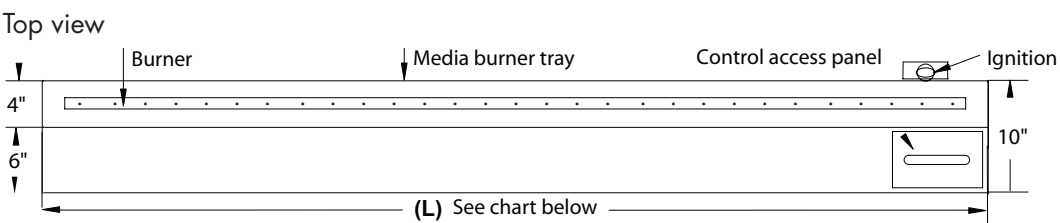

Height of Standard Unit = 5" Electronic Ignition version = 6"

Model Number	Overall Length (L)	Unit Height	Fireplace Width Min.	Input Rate BTU/hr N.G.	L.P.	Number Orifice N.G. (L.P.)	Orifice Size N.G.	L.P.
LBS24	24"	5" (6")*	28"	41,000	33,500	2 (1)	44	49
LBS36	36"	5" (6")*	40"	61,000	54,000	3 (1)	44	43
LBS48	48"	5" (6")*	52"	82,000	72,000	4 (1)	43	38
LBS60	60"	5" (6")*	64"	102,000	90,000	5 (2)	43	46
LBS72	72"	5" (6")*	76"	116,000	110,000	6 (2)	43	43
LBS84	84"	5" (6")*	88"	129,000	128,000	7 (2)	43	41
LBS96	96"	5" (6")*	100"	142,000	146,500	8 (2)	43	38

Minimum fireplace depth required = 14" Minimum fireplace height required = 18" \* Electronic Ignition Version

**IMPORTANT NOTES:** Critical notes and details are available at [www.sparkfires.com](http://www.sparkfires.com) for proper and safe installation of the Linear Burner Systems. Minimum ventilation air requirements AND details of how to properly provide this air to the underside of these burners is provided. A minimum requirement of (1) 4" round (+12 sq inches) ventilation air supply for a 2' or 3' burner. At least (2) or more 4" round (each +12 sq inches) fresh air supplies required for larger burners.

Minimum fireplace depth required 20"  
Minimum fireplace height required 18"  
\* Electronic Ignition Version

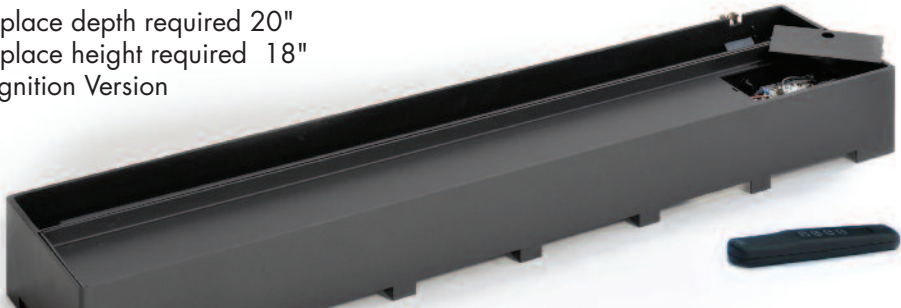



## Linear Burner System Outdoor\*

p. 866.938.3846

**Model No.** LOD24 | LOD36 | LOD48 | LOD60 | LOD72 | LOD84 | LOD96

Exterior Dimension	Electronic ignition 2' - 8' W x 6" H x 10" D
Gas Type	Natural or LP/Propane
On/Off	Remote Control
Venting Options	n/a
Electric	110 V. with battery back-up
Accessory Equipment	n/a
Burner Appearance	Linear media burner in lengths from 2' to 8' in 1' increments. Burner is submerged into bed of broken tempered glass
Open Air Fire	No glass
Media Options	Tempered glass over the burner and approved SPARK fire objects as a topcoat
Fireplace Configuration	Non-combustible structure. This outdoor appliance is perfect for tabletop, fire pit and single or multi-sided view fireplace applications.
Cooling Air Supply To Base Of Unit	12 sq. inches of fresh air per linear foot of burner with 1/4" air gap around entire assembly
BTU Input	Varies on appliance length
Color	Stainless steel
Certifications	Certified by Omni-Test Laboratories, ANSI Z21.97-CSA 2.41-2012 "Outdoor Decorative Gas Appliance" CGA 2.17-M91 (R2009) "Gas Fired Appliances for Use at High Altitudes"

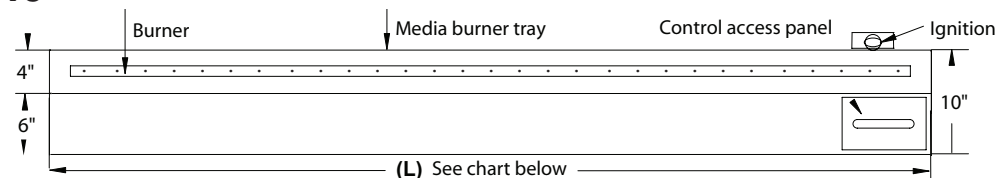

Model No.	Overall Length (L)	Burner Length (L)	Unit Height	Input Rate N.G. BTU/hr	Input Rate Propane BTU/hr
LOD24	24.125"	20"	6"	41,000	33,500
LOD36	36.125"	32"	6"	61,000	54,000
LOD48	48.125"	44"	6"	82,000	72,000
LOD60	60.125"	54"	6"	102,000	90,000
LOD72	72.125"	68"	6"	116,000	110,000
LOD84	84.125"	80"	6"	129,000	128,000
LOD96	96.125"	92"	6"	142,000	146,000

**IMPORTANT NOTES:** Critical notes and details are available at [www.sparkfires.com](http://www.sparkfires.com) for proper and safe installation of the Linear Burner Systems. Minimum ventilation air requirements AND details of how to properly provide this air to the underside of these burners is provided. A minimum requirement of +12 sq. inches per linear ft. of burner of continuous fresh air supply to the underside of the burner.

**\*The Linear Burner System Outdoor should not be installed in areas susceptible to saltwater corrosion or high winds. This product is not warranted against either condition.**

**\*SPARK Modern Fires wants to help you achieve your fireplace vision. All installation plans must be reviewed and approved by SPARK Modern Fires. Please provide plan view and section drawings electronically, along with a rendering of the finishing details, and we will help you plan it properly.**

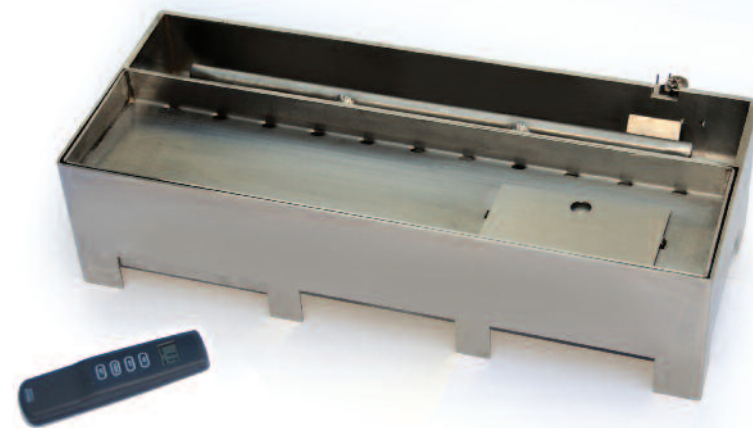

Fire Ribbon 3 ft Outdoor Available in one-sided view or two-sided view

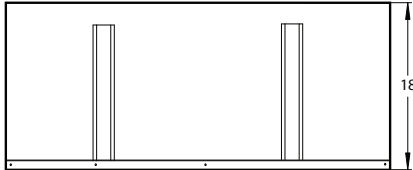
Model No.	SS36 STVT37	SS48 STVT49	Top view SS36 STVT37	
Viewing Area	36"W x 17.31"H	48"W x 13.75"H		
Exterior Dimensions	48"W x 29.75"H x 18"D	60"W x 25.75"H x 18"D		
Framing Dimension	49" W x 34" H x 18.5" D	61" W x 30" H x 18.5" D		
Gas type*	Natural or LP/propane	Natural or LP/propane		
Gas connection	½" pipe	½" pipe		
On/off	Remote control	Remote control		
Electric	110v.	110v.		
BTU input Natural gas	40,000 BTU/h	60,000 BTU/h		
LP/propane	38,000 BTU/h	56,000 BTU/h		
Doors/glass	3" glass across front to protect flame from wind and rain.	3" glass across front to protect flame from wind and rain.		
Interior color	Stainless steel interior firebox	Stainless steel interior firebox		
Max Supply Pressure	& surround 10.5" w.c. for natural gas	& surround 10.5" w.c. for natural gas		
Min Supply Pressure	13.0" w.c. for LP/Propane	13.0" w.c. for LP/Propane		
Certification	5" w.c. for natural gas	5" w.c. for natural gas		
	11.0" w.c. for LP/Propane	11.0" w.c. for LP/Propane		
	Omni-Test Laboratories	Omni-Test Laboratories		
	AANSI Z21.97 - CSA 2.41-2014	AANSI Z21.97 - CSA 2.41-2014		
	"Outdoor Decorative Gas Appliances"	"Outdoor Decorative Gas Appliances"		
	CGA 2.17-M91(R2009) "Gas Fired Appliances for Use at High Altitudes"	CGA 2.17-M91(R2009) "Gas Fired Appliances for Use at High Altitudes"		
Options*				
*Must be specified at time of ordering.	Fire Objects*	Fire Objects*		

**\*The Fire Ribbon 3 ft Outdoor should not be installed in areas susceptible to saltwater corrosion or high winds. This product is not warranted against either condition.**

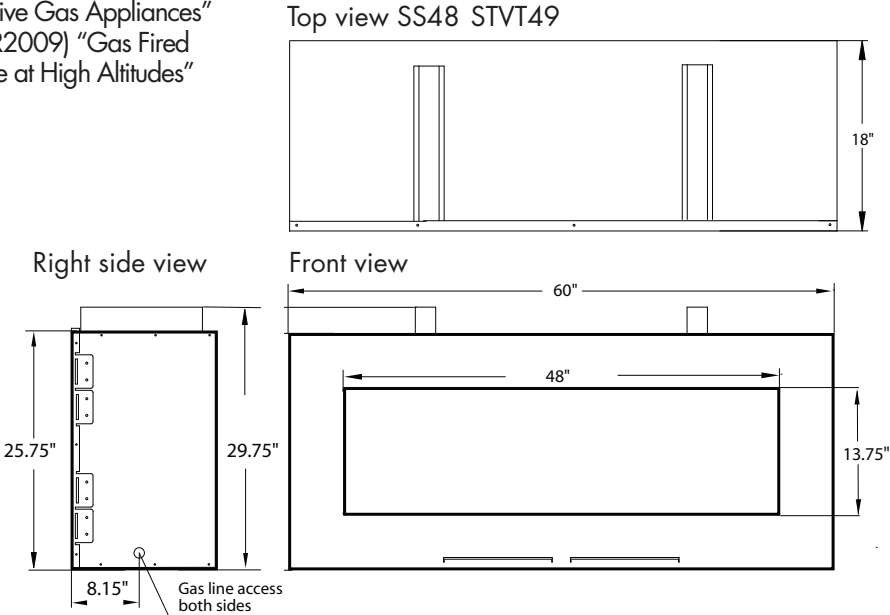
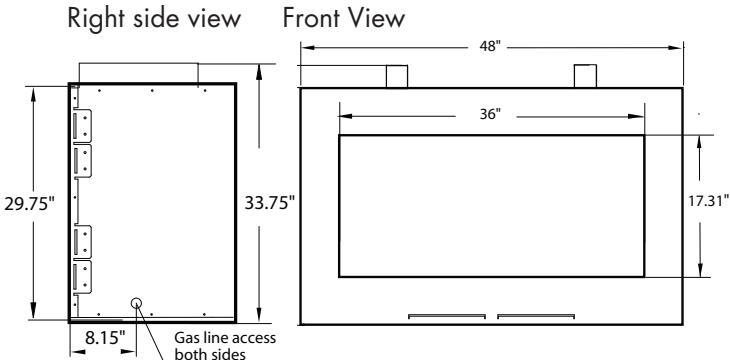



## Fire Ribbon 3 ft Outdoor Available in one-sided view or two-sided view

p. 866.938.3846

Model No.	SS60 STVT61	SS72 STVT73
Viewing Area	60"W x 13.75"H	72"W x 13.75"H
Exterior Dimensions	72"W x 25.75"H x 18"D	84"W x 25.75"H x 18"D
Framing Dimension	73" W x 32" H x 18.5" D	85" W x 32" H x 18.5" D
Gas type*	Natural or LP/propane	Natural or LP/propane
Gas connection	½" pipe	½" pipe
On/off	Remote control	Remote control
Electric	110v with battery backup	110v with battery backup
BTU input Natural gas	75,000 BTU/h	90,000 BTU/h
LP/propane	75,000 BTU/h	90,000 BTU/h
Doors/glass	3" glass across front to protect flame from wind and rain.	3" glass across front to protect flame from wind and rain.
Interior color	Stainless steel interior firebox & surround	Stainless steel interior firebox & surround
Max Supply Pressure	10.5" w.c. for natural gas 13.0" w.c. for LP/Propane	10.5" w.c. for natural gas 13.0" w.c. for LP/Propane
Min Supply Pressure	5" w.c. for natural gas 11.0" w.c. for LP/Propane	5" w.c. for natural gas 11.0" w.c. for LP/Propane
Certification	Omni-Test Laboratories AANSI Z21.97 - CSA 2.41-2014 "Outdoor Decorative Gas Appliances" CGA 2.17-M91(R2009) "Gas Fired Appliances for Use at High Altitudes"	Omni-Test Laboratories AANSI Z21.97 - CSA 2.41-2014 "Outdoor Decorative Gas Appliances" CGA 2.17-M91(R2009) "Gas Fired Appliances for Use at High Altitudes"
Options*	Fire Objects	Fire Objects

\*Must be specified at time of ordering.

**\*The Fire Ribbon 3 ft Outdoor should not be installed in areas susceptible to saltwater corrosion or high winds. This product is not warranted against either condition.**

Top view & right side view of SS60 STVT61

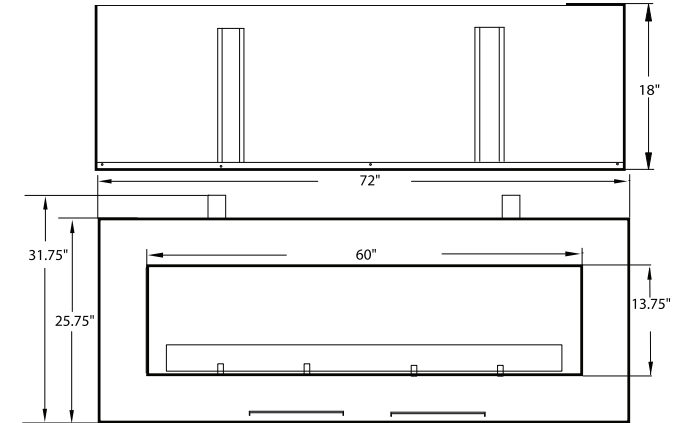

Top view & right side view of SS72 STVT73

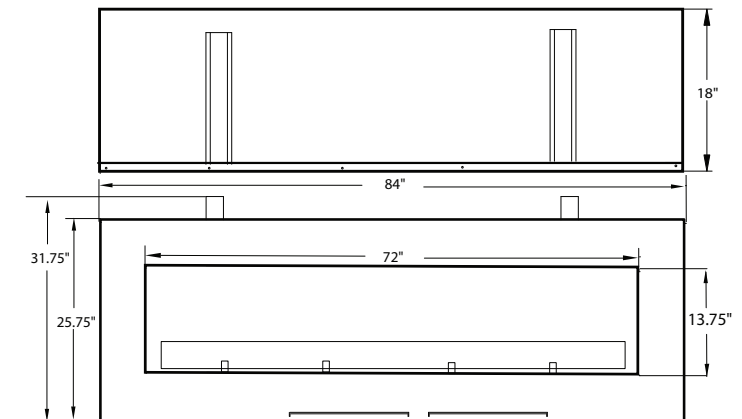

The CUBE

Model No.	34
Exterior Dimension	34.5" W x 28.5" H x 34.5" D
Gas Type	Natural or LP/Propane
On/Off	Manual switch on unit
Venting Options	n/a
Electric	n/a
Accessory Equipment	n/a
Burner Appearance	Burner is submerged into bed of broken tempered glass
Open Air Fire	n/a
Media Options	Tempered glass over the burner and approved SPARK fire objects as a topcoat
Fireplace Configuration	n/a
Cooling Air Supply To Base Of Unit	n/a
BTU Input	60,000Ng 54,000Lp BTU/h
Color	Stainless steel, Red
Certifications	OMNI-Test Laboratories ANSI Z21.97-2010 CSA CAN 401-0-04-5 Outdoor decorative appliance
Options*	Safety Screen* Fire Objects* Protective matt*
*Must be specified at time of ordering.	

**\*The CUBE should not be installed in areas susceptible to saltwater corrosion or high winds. This product is not warranted against either condition.**

Top view

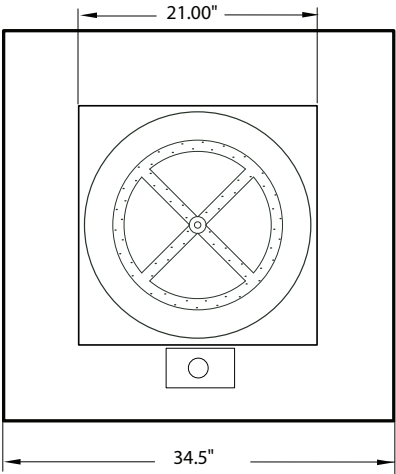

Front view

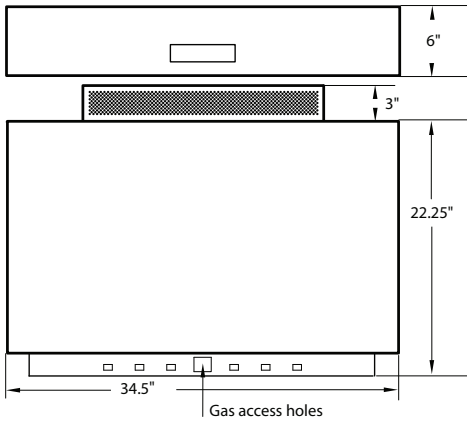





## Clean & Green

SPARK products are energy-efficient and designed to be as clean-burning as possible, nearly eliminating any carbon monoxide or soot. We are working to make sustainable building technologies accessible to everyone.

## Stunning & Sustainable

SPARK is the fire of choice at the flawlessly designed Margarido House in Oakland California, built with top-to-bottom green strategies and featuring energy efficiency that surpasses California's tough standards by 55%.



## Ordering **SPARK** Quick & Easy

At SPARK, we believe reducing paper waste is a practical way to promote everyday green living. Order green—download your order form at [www.sparkfires.com](http://www.sparkfires.com) and e-mail it to us.

Or you can call SPARK directly at **203.791.2725** and speak to one of our associates who will help you with your order.

### **Spark Modern Fires**

99B Greenwood Avenue | Bethel, CT 06801  
Phone: 203.791.2725 | Fax: 203.798.8661

### **Return Policy:**

We will accept returns made within three months of the ship date. Products can be returned for full refund provided the product has not been installed and is received by us in resalable condition. The customer is responsible for arranging and paying for return shipping. Please contact us at 203.791.2725 for a **Return Authorization Number** and return shipping address.

1. Take pictures of the unit.
2. Product must be placed on a sturdy pallet larger than the fireplace.
3. Fireplace should be completely covered front to back with heavy cardboard and then fastened with plastic strapping to the pallet.
4. Bubble-wrap the entire fireplace.
5. Use a reputable freight carrier. Remember you are responsible for the safe return of the product to our dock.

### **Claims:**

All claims for damage or shortage must be reported within 5 days from receipt of merchandise. Examine all shipments carefully when received and before signing Bill of Lading or freight bill, and have any damage or shortage noted therein. Concealed loss or damage should be reported immediately to Spark Modern Fires. Failure to do this deprives consignee of his claim rights.

### **Before Installing Your SPARK:**

SPARK fireplaces are easy to install, provided you read and follow the instructions given in SPARK's Installation Manual.

Keep in mind these quick safety tips.

### **SPARK's Safety Checklist:**

- Always check codes with your local municipality to ensure the SPARK fireplace you've chosen is approved in your location.
- Always hire a qualified installer as required by national codes.
- Never install a SPARK vent-free fire in a bedroom or bathroom—they are not allowed in these spaces.
- Always install a SPARK direct-vent fire with Simpson DuraVent Pro venting; they are the only approved venting for these products.
- Please have your installer call or e-mail SPARK with any specific questions prior to receiving/installing your fireplace. We are always happy to assist and ready to give guidance.
- Remember that the time to contact SPARK with questions is before installation—and especially before completion! Failure to do so may result in extensive and costly repairs.



[www.sparkfires.com](http://www.sparkfires.com)

